

2021 Jeep Grand Cherokee L

Manual Park Release



WARNING:

You should be seated in the driver's seat with your foot firmly placed on the brake pedal to maintain control of the vehicle before activating the Manual Park Release. If possible, you should apply the parking brake. Activating the Manual Park Release will allow your vehicle to roll away if it is not secured or properly connected to a tow vehicle. Activating the Manual Park Release on an unsecured vehicle could lead to serious injury or death for those in or around the vehicle.

To move the vehicle in cases where the transmission will not shift out of PARK (P) (such as a depleted battery), a Manual Park Release is available.

FOLLOW THESE STEPS TO ACTIVATE THE MANUAL PARK RELEASE:

- 1 Apply firm pressure to the brake pedal while seated in the driver's seat.
- 2 Apply the parking brake, if possible.
- 3 Using a flathead screwdriver or similar tool, remove the Manual Park Release access cover, which is to the lowerleft of the steering column.

Note: Insert the flathead screwdriver or similar tool in the lower notch of the access cover and gently rotate clockwise.

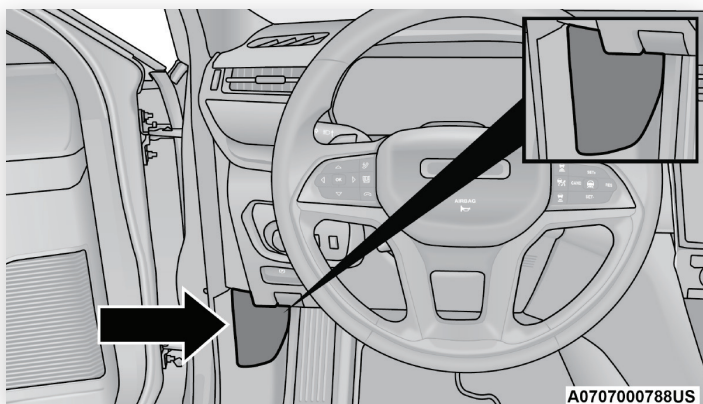

Manual Park Release Access Cover

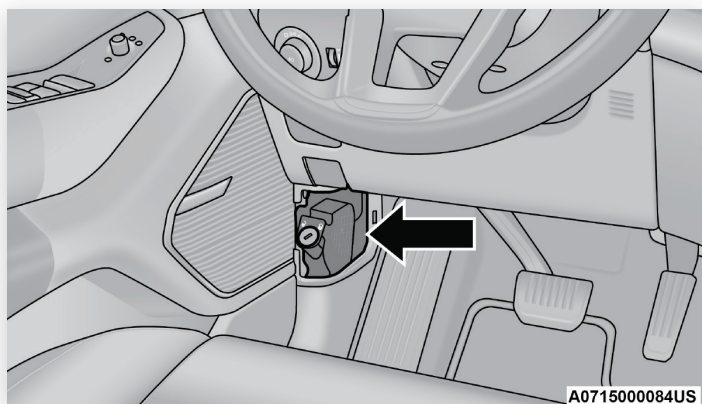

Manual Park Release Location

- 4 Remove the orange lock plug by turning it a quarter turn counterclockwise.

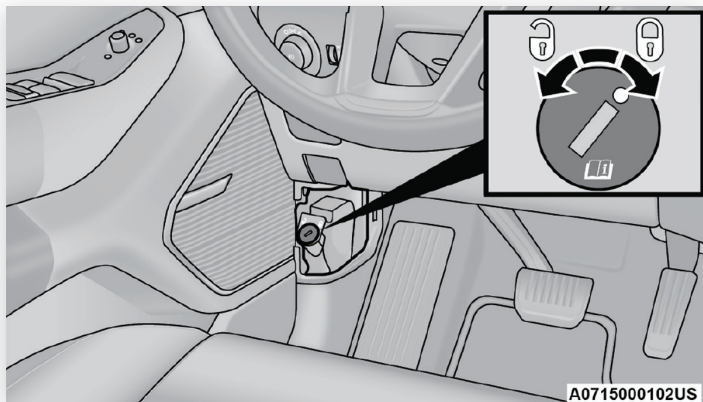

Manual Park Release Location

- 5 Pull the lock plug out as far as it will go, then release it. The transmission should now be in NEUTRAL (N), allowing the vehicle to be moved.

Note: When the lever is locked in the released position, the lock plug and tether will remain outside of the trim panel and the access cover cannot be reinstalled.

- 6 Release the parking brake only when the vehicle is securely connected to a tow vehicle.

TO RESET THE MANUAL PARK RELEASE:

- 1 Apply firm pressure to the brake pedal while seated in the driver's seat.
- 2 Pull the lock plug out again, then release it.
- 3 Allow the tether to retract with the lever back to its original position.
- 4 Verify that the transmission is in PARK (P).
- 5 Confirm that the tether has retracted fully, then firmly push the orange lock plug back to the locking position within the housing. Re-install the access cover. If the access cover cannot be re-installed, repeat steps 1 through 4.